

ProxPro® II Reader

New Generation 125 kHz Proximity Card Reader

Application

HID's ProxPro II proximity reader for access control combines performance, reliability, and ease of installation into a two-piece, weatherproof potted enclosure. International users will appreciate the multilingual installation manual, lower voltage requirement and flexible mounting options.

Features

- Two-piece reader design allows for easy installation.
- Available with a Wiegand or Clock-and-Data interface.
- Provides high reliability, consistent read range and low power consumption.
- Features include multicolor LED and internal control or host control of the LED and beeper.
- Mounts directly on metal with minimal impact on the read range performance. Optional kit enables mounting behind glass.
- Compare features of the ProxPro II to the original ProxPro reader (still available):

Feature	ProxPro	ProxPro II
Multilingual installation manual	No	Yes
Glass mounting kit (optional)	Yes	Yes
Supply Voltages	12V and 24V	5V and 12V
Voltage Range min/max	10 / 28.5VDC	5 / 16VDC
Current Draw avg/peak	100 / 120 mA	25 / 125 mA
Read Range at 12VDC (ProxCard® II/ISOProx® II)	8" (20 cm) / 7" (17 cm)	9" (22 cm) / 8" (20cm)
IP Rating	IP55	IP65
European/Asian mounting holes	No	Yes (vertical)
Weatherproofing method	Rubber O ring	Fully potted electronics
Cover installation method	4 screws, then snap in bezel	Snap on cover
Custom molded logo	No	Available (one-time tooling charge)
Termination method	Screw Terminals	Wire Pigtail
Metal compensation	Jumper	No, but provides equivalent performance on metal
LED/Beeper configuration	DIP Switch or Command Card	Command Card
Custom Firmware	Socketed Processor, change part	Order from factory
Tamper Switch	Yes	No, but electronics are potted to prevent tampering
Keypad Version available	Yes	No
Wiegand Pullup Select 5 or 12V	DIP Switch	No
Serial Version available	Yes	No



5455 (Wiegand)
5458 (Clock-and-Data)

ProxPro® II Reader

Features

Installation: easy, streamlined installation procedure is consistent with HID's ThinLine® II, MiniProx® and ProxPoint® Plus readers. Included installation manual features instructions in English, French, German, Spanish, Portuguese, Chinese and Japanese.

Mounting: mounts on a single-gang electrical box for easy installation. Mounting holes are provided for European and Asian J-boxes. Mounts directly on metal with minimal impact on read range performance. An optional kit enables mounting behind glass.

Audiovisual indication: an LED flashes green and the beeper sounds when a proximity card is presented to the reader. The multicolor LED and beeper can also be controlled individually by the host system.

Diagnostics: on reader power-up, an internal self-test routine checks and verifies the setup configuration, determines the internal or external control of the LED and beeper and initializes reader operation. An additional external loop-back test allows for the reader outputs and inputs to be verified without the use of additional test equipment.

Indoor/outdoor design: sealed in a rugged, weatherized polycarbonate enclosure designed to withstand harsh environments, providing reliable performance and a high degree of vandal resistance. Two-piece reader design allows for easy installation.

Easily interfaced: Wiegand output model interfaces with all existing Wiegand protocol access control systems. Clock-and-Data (magnetic stripe) model interfaces with most systems that accept magnetic stripe readers.

Security: recognizes card formats up to 84 bits, with over 1.93×10^{25} unique codes.

Warranty: warranted against defects in materials and workmanship for life from date of shipment. See complete warranty policy for details.

Options:

- **Termination:** 18" (45 cm) pigtail standard, 9' (2.7m) available by special order.
- **Mounting:** glass mounting kit available separately
- **Color:** white, beige, charcoal gray or black
- **LED and beeper operation**

Part numbers:

Base Part Number: 5455 Wiegand
Base Part Number: 5458 Clock-and-Data interface
Description: Tri-State LED, internal beeper on
Glass Mount Kit: 5455AGM00

Please see "How to Order Guide" for a description of the options and associated part numbers. The How to Order Guide can be downloaded in PDF format from:

www.HIDCorp.com/support.

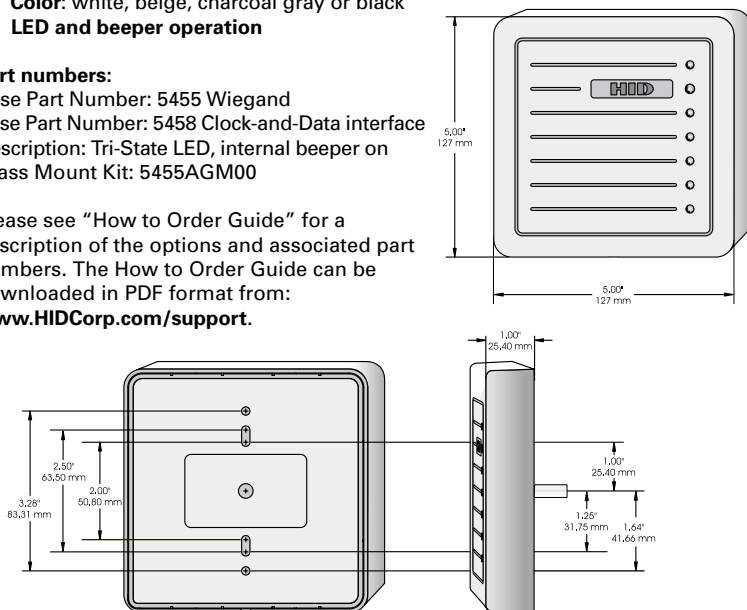

An ASSA ABLOY Group company

www.HIDCorp.com

9292 Jeronimo Road
Irvine, CA 92618-1905 U.S.A.
+1 (949) 598-1600 (800) 237-7769
FAX +1 (949) 598-1690



ASSA ABLOY

Specifications

Typical maximum* read range:

- ProxCard® II card - up to 9" (22 cm)
- ISOProx® II card - up to 8" (20 cm)
- DuoProx® II card - up to 8" (20 cm)
- Smart ISOProx® card - up to 8" (20 cm)
- Smart DuoProx® card - up to 8" (20 cm)
- HID Proximity and MIFARE® card - up to 8" (20 cm)
- ProxKey® II keyfob - up to 4" (10 cm)
- ProxCard® Plus card - up to 4" (10 cm)

*Depending on local installation conditions.

Dimensions:

5.00" x 5.00" x 1.00"
(12.7 x 12.7 x 2.54 cm)

Material: Polycarbonate UL 94

Power supply:

5-16 VDC
Linear power supplies are recommended.

Current requirements:

Average: 25 mA at 12 VDC
Peak: 125 mA at 12 VDC

Operating temperature:

-22° to 150° F (-30° to 65° C)

Operating humidity:

0-95% relative humidity non-condensing

Weight: 13.6 oz. (385 g)

Transmit frequency: 125 kHz

Excite frequency: 125 kHz

Certifications:

Canada/UL 294 Listed
FCC Certification, United States
Canada Certification
CE Mark
EU and CB Scheme Electrical Safety (EN60950 and IEC60950 ITE Electrical Safety)
Fifteen EU Countries under the R&TTE Directive (EN 300 330 - SRD, and ETS 300 683 - EMC)
Australia C-Tick (pending)
New Zealand (pending)
Taiwan (pending)

Cable distance:

Wiegand interface: 500 feet (150 m)
Clock-and-Data interface: 50 feet (15 m)
Recommended cable is ALPHA 1295 (22 AWG) 5 conductor minimum stranded with overall shield or equivalent. Additional conductors may be required for LED or beeper control.

LIT5455DS 11/01.